

TO FARGO

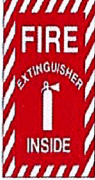

BELLA VISTA II HANFORD

The Following Items Located at the Sales Office:



PRIMARY EXIT

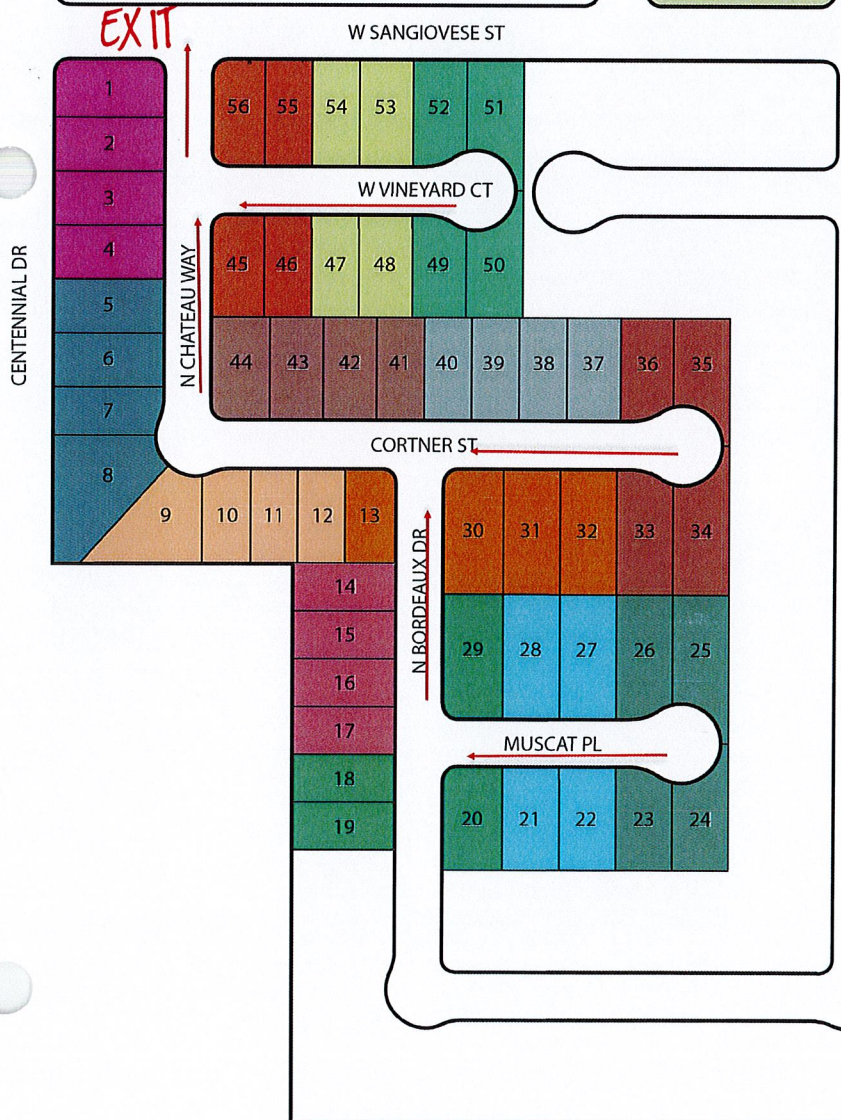
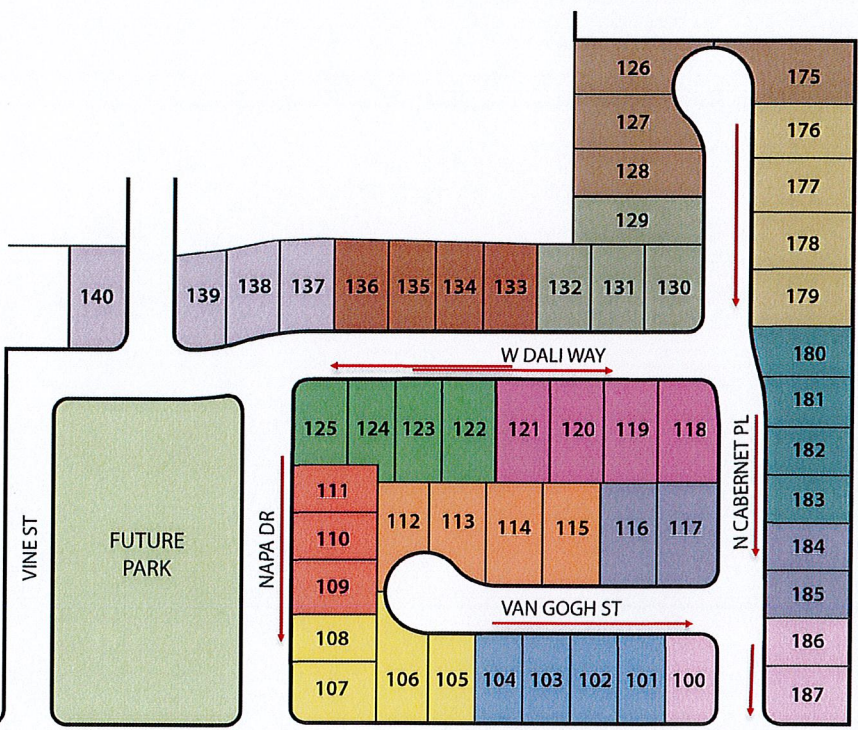

Qty Lots	Sales Phase
4	Phase 37
4	Phase 38
4	Phase 39
4	Phase 40
4	Phase 41
4	Phase 42
4	Phase 43
4	Phase 44
4	Phase 45
4	Phase 46
4	Phase 47
4	Phase 48
4	Phase 49
4	Phase 50
4	Phase 51
4	Phase 52
3	Phase 53
3	Phase 54
4	Phase 55
4	Phase 56
4	Phase 57
4	Phase 58
4	Phase 59
4	Phase 60
4	Phase 61
4	Phase 62
4	Phase 63
4	Phase 64
110	

UNIT 3

UNIT 4

EMERGENCY

For all Medical Emergencies please call

AMBULANCE: 9-1-1

In case of emergency call: Hanford Fire Department
350 W. Grangeville Blvd., Hanford, CA 93230
(559) 585-2545

FIRE/RESCUE: 9-1-1

Adventist Health Hanford
115 Mall Dr., Hanford, CA 93230
(559) 582-9000

HOSPITAL: _____

John M. Riddle
869 W. Lacey Blvd, Hanford, CA 93230
(559) 582-2929

PHYSICIAN: _____

**ALTERNATE
PHYSICIAN:** MPN Medical Access
Assistant (888) 782-8338

POLICE: 9-1-1 Hanford Police Department
In case of emergency please call 425 N. Irwin St., Hanford, CA 93230
(559) 585-2540

OSHA: Fresno District Office
2250 Mariposa Street, Rm. 4000 Fresno, CA 93721
Phone: (559) 445-5302

POSTING IS REQUIRED BY TITLE 8 SECTION 1512(e)

2251 Elizabeth Dr
Hanford, CA 93230

- ↑ 1. Head north on Elizabeth Dr toward W Van Gogh St
0.1 mi
- ↘ 2. Turn right onto W Dali Wy
0.1 mi
- ↘ 3. Turn right onto Centennial Dr
1.3 mi
- ↙ 4. Turn left onto Greenfield Ave
1.8 mi
- ↙ 5. Turn left onto W Lacey Blvd
121 ft
- ↘ 6. Turn right
157 ft

1 Destination will be on the right

869 W Lacey Blvd
Hanford, CA 93230

These directions are for planning purposes only. You may find that construction projects, traffic, weather, or other events may cause conditions to differ from the map results, and you should plan your route accordingly. You must obey all signs or notices regarding your route.



Provider Directory
5/24/2022

Search Criteria

Radius: 15 Miles
City: Hanford
State: CA
Zip Code: 93230
Specialties: Urgent Care Center, Family Practice / General Practice, Emergency Medicine, Frontline Industrial Clinic

While we take great care in keeping our on-line directory information current and accurate, our network of participating providers is continually changing. We recommend that if you have questions regarding availability of the network providers please call State Fund's Medical Access Assistant Team at (888) 782-8338.

Medical Access Assistant (MAA)

Call: (888) 782-8338 or Email: StateFundMPNMAA@scif.com

For more information regarding the Medical Provider Network (MPN), or to report provider listing inaccuracies.

To reach the MPN contact or to obtain a copy of any notification regarding the MPN that is required by regulations to be given to any employee, please call 877-636-0606. Approved locations are listed in an MPN provider's listing. Inaccuracies reported through the contact method stated on the provider directory listing will be updated on the provider listing within the regulatory mandated timeframes. This MPN's provider listing is updated quarterly, at a minimum. Please be advised that information on this MPN website is subject to change without notice.

Last Network Update: 5/20/2022

Search Results

Kent Takemoto, MD

Doc Live

COUNTY

(800) 403-9981

Family Practice / General Practice

Telehealth

JOHN RIDDLE, MD

CENTRAL VALLEY COMPREHENSIVE

CARE INC

869 W LACEY BLVD

STE 105

HANFORD, CA 93230

KINGS COUNTY

(559) 582-2929

Family Practice / General Practice

2.3 Miles

WILLIAM FOXLEY, MD

TOTAL CARE MEDICAL GROUP SAN

JOAQUIN TOTALCARE LLC

1080 N IRWIN ST

HANFORD, CA 93230

KINGS COUNTY

(559) 582-2684

Family Practice / General Practice

2.3 Miles

TOTAL CARE MEDICAL GROUP INC

1080 N IRWIN ST

HANFORD, CA 93230

KINGS COUNTY

(559) 688-8080

Frontline Industrial Clinic

Medical Group

2.3 Miles

Only providers from the above group that are individually listed in the Provider Finder are considered part of the MPN and may be selected as the treating physician



2251 Elizabeth Drive, Hanford, CA to 869 West Lacey Boulevard, Hanford, CA

Drive 3.5 miles, 8 min

JOHN RIDDLE, MD (CENTRAL VALLEY COMPREHENSIVE CARE INC)

2251 Elizabeth Dr
Hanford, CA 93230

- ↑ 1. Head north on Elizabeth Dr toward W Van Gogh St
0.1 mi
 - ↷ 2. Turn right onto W Dali Wy
0.1 mi
 - ↷ 3. Turn right onto Centennial Dr
1.3 mi
 - ↶ 4. Turn left onto Greenfield Ave
1.8 mi
 - ↶ 5. Turn left onto W Lacey Blvd
121 ft
 - ↷ 6. Turn right
157 ft
- i** Destination will be on the right

869 W Lacey Blvd
Hanford, CA 93230

These directions are for planning purposes only. You may find that construction projects, traffic, weather, or other events may cause conditions to differ from the map results, and you should plan your route accordingly. You must obey all signs or notices regarding your route.

2251 Elizabeth Dr
Hanford, CA 93230

- ↑ 1. Head north on Elizabeth Dr toward W Van Gogh St
0.1 mi
- ↪ 2. Turn right onto W Dali Wy
0.1 mi
- ↪ 3. Turn right onto Centennial Dr
0.9 mi
- ↶ 4. Turn left onto Grangeville Blvd
1.9 mi
ⓘ Pass by Subway (on the right in 1.4 mi)
- ↪ 5. Turn right onto N Irwin St
0.5 mi
ⓘ Destination will be on the right

1080 N Irwin St
Hanford, CA 93230

These directions are for planning purposes only. You may find that construction projects, traffic, weather, or other events may cause conditions to differ from the map results, and you should plan your route accordingly. You must obey all signs or notices regarding your route.